

Our selection of fittings enhances the value, the areas of application and convenience of Titeflex convoluted hose. With these fittings, most installation needs are easily met. Please consult us for any designs or applications not pictured here.

Convoluted hose fittings feature the exclusive Titeflex progressive swaging method of attachment. When attached correctly, the innercore and insert form a permanent assembly. The positive braid lock assures that strain is absorbed by the braid, not the hose innercore, ensuring hose integrity.

CRIMP ATTACHMENT:

Hose may be crimped using numerous standard hose crimping machines. For information on this alternate method of attachment and appropriate applications, please consult us.

MATERIALS:

Male pipe and female inserts are available in carbon steel and type 316 stainless steel. Collars for the preceding fittings are either carbon steel or type 304 stainless steel.

Note: Carbon steel collars may be specified with stainless steel inserts, where only wetted surfaces require corrosion resistance.

AVAILABILITY:

Convoluted hose assemblies can be fabricated by Titeflex or authorized Titeflex distributors. To assure factory-made reliability for distributor assemblies, our distributors are equipped with Titeflex-designed and approved field swaging tools.

MALE PIPE



STAINLESS STEEL PART NUMBER	CARBON STEEL PART NUMBER	SIZE IN.	THREAD	NOMINAL ID IN.
Y53308-100	Y53308-101	1/2	1/2 – 14	.378
Y53312-100	Y53312-101	3/4	3/4 – 14	.630
Y53316-100	Y53316-101	1	1 – 11-1/2	.849
Y53320-100	Y53320-101	1-1/4	1-1/4 – 11-1/2	1.069
Y53324-100	Y53324-101	1-1/2	1-1/2 – 11-1/2	1.306
Y53332-100	Y53332-101	2	2 – 11-1/2	1.756

JIC - FEMALE SWIVEL (37° SEAT)



STAINLESS STEEL PART NUMBER	CARBON STEEL PART NUMBER	SIZE IN.	THREAD	NOMINAL ID IN.
Y53508-100	Y53508-101	1/2	3/4 – 16	.378
Y53512-100	Y53512-101	3/4	1-1/16 – 12	.630
Y53516-100	Y53516-101	1	1-5/16 – 12	.849
Y53520-100	Y53520-101	1-1/4	1-5/8 – 12	1.070
Y53524-100	Y53524-101	1-1/2	1-7/8 – 12	1.305
Y53532-100	Y53532-101	2	2-1/2 – 12	1.755

SANITARY FITTING

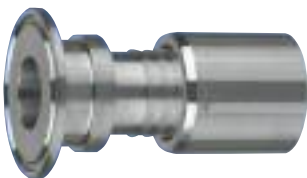

STAINLESS STEEL PART NUMBER	SIZE IN.	FACE DIAMETER	NOMINAL ID IN.
Y51124-3	1-1/2	1.984	1.310
Y51132-3	2	2.516	1.756

WARNING

These products can be used to convey hazardous fluids, steam, and other dangerous materials which can cause personal injury or property damage if released through misuse, misapplication, or damaged. The user is responsible to analyze each application prior to specifying any product from this catalog. Due to the wide variety of operating conditions and applications, the user, through personal analysis and testing, is solely responsible for final product selection and meeting all performance, safety, and warning requirements. Careful selection, proper assembly and use of hose fittings and accessories is essential for the safe and warranted operation of the hose assembly.